



WPM Modular Folding Carton Production System



The WPM Advantage

Designed for installation in line with printing presses or as an offline for consolidated production operations, WPM can design a complete folding carton scoring and diecutting production system to suit your specific needs. WPM rotary die cutting technology is tailored to your needs and will improve your die cutting results, and therefore your profits. WPM TruCut™ dies provide quality cutting and dependable results at lower costs than traditional machined dies and lead to improved profits for WPM users. This unique cutting system provides endless opportunities for intricate die cutting, perforating, scoring, embossing or kiss cutting. Consider the WPM advantage for your production process:

- System design. A state-of-the-art rotary die cutter and die specifically made to work together.
- MicroTouch™ design on-the-run gap adjustment to extend die wear, and shorten makeready.
- Regulated cutting pressure for quality results.
- Elimination of die re-sharpening, shimming under the die, or bearer re-grinding.
- A new level of precision adjustment which enables the operator to control the cutting process with kiss contact of the die against the anvil for cleaner cutting and minimal anvil wear, yet longer die impression life.
- Die and anvil cylinders manufactured from alloy steel forgings, designed with short, rigid journals to assure minimum deflection.
- Anvil cylinders which are deep hardened and super finished to improve cutting results of fine filament materials.
- Scoring and diecutting registered on separate cylinders for lower die costs.



Folding Carton System Standard Features

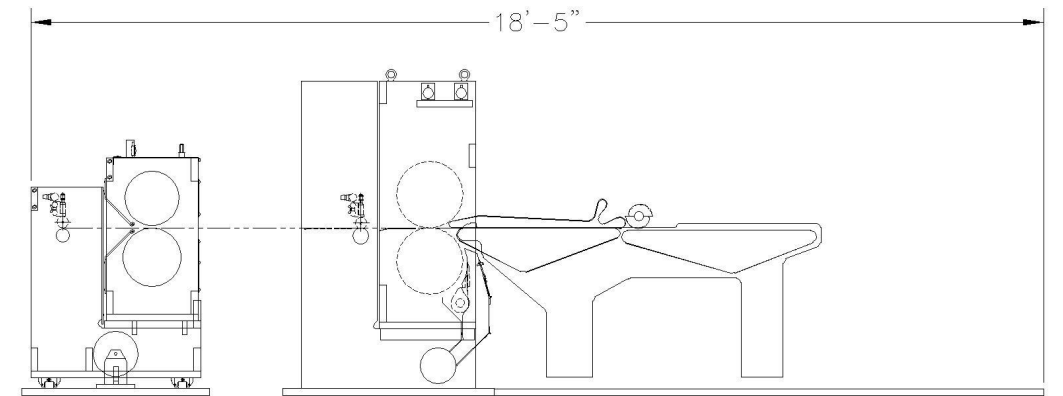

- WPM grid style bolt pattern on die cylinder to mount WPM TruCut dies.
- Hardened, ground, and plated, solid steel anvil cylinder.
- Pinned or non-pinned anvil cylinders as needed for scrap removal.
- Modular design for repeat changes.
- Available in 22", 26", 32", and 38" standard web widths. Other web widths available upon request.
- Oil lubricated main bearings, for up to 1000fpm operation.
- Exclusive WPM MicroAdjust vertical gap adjustment for ease of cutting makeready, and elimination of Bearers.
- Micro dial indicator gauges on both sides of the unit for instant die gap measurement readout.
- Calibrated scale on die cylinder for die registration.
- Stripper shaft and comb assembly for scrap removal.
- Complete independent drive and register control system.

The TruCut Die Advantage



All WPM Die Cutting System are capable of using the unique TruCut Die. The molded to size, steel rule die, gives TruCut Die users a competitive advantage by providing the quality and accuracy of solid steel crush cut tooling with the added flexibility of a changeable mounted plate, all at a cost effective price.

Western Printing Machinery Company Finishing Technology Division

Corporate Offices
9229 Ivanhoe Street
Schiller Park, Illinois 60176-2348 USA
Main (847) 678-1740 • Fax (847) 678-6176

Cutting Technology Division
9228 Ivanhoe Street
Schiller Park, Illinois 60176-2306 USA

WPM Europe Limited
Units 1 & 2 Sam Brown Industrial Estate
Dog & Gun Lane, Whetstone
Leicester LE8 6LJ United Kingdom

www.wpm.com

WPM, the WPM Logo, WPM Europe, the WPM Europe logo, TruCut, Tru-Cut, TruCut AdvantEdge, Tru-Cut AdvantEdge, TruLock, Tru-Lock, TruImage, MicroTouch, Micro-Touch, RotaCutter, Rota-Cutter, ServoRotaCutter, ServoSealer, DieCutter, FlexDieCutter, FastTrack, FlexGluer, SlimGluer, AngleBar, Gilda, the Gilda logo, KnifeLocator, and Excellence In Finishing are Trademarks or Registered Trademarks of Western Printing Machinery Company. All other brand and product names are Trademarks or Registered Trademarks of their respective companies or organizations.